

Macurco™ Optional White Housing Cover

MACURCO
GAS DETECTION



For the Macurco 6-Series and 12-Series



A white housing cover option for Macurco 6-Series and 12-Series products

The new Macurco White Housing Cover option is for those installations where looks matter just a little bit more than usual. The original gray Macurco 6-Series and 12-Series housing cover is handsomely commercial looking in appearance, whereas the new White Housing Cover has a more finished style better suited to the décor of interior applications. While the original gray cover is very much at home in parking garages, maintenance facilities, boiler rooms or other commercial settings, the new Macurco White Housing Cover is better suited to offices, auditoriums, retail locations, healthcare facilities or other institutions that require low level gas detection and control in an aesthetically pleasing form.

Options

- Available for both Macurco 6-Series and 12-Series products
- Offered in all Macurco gas detection options
- Features a wire knock-out for use with plug-in power supplies

Installation

- Mounts on a standard 4" x 4" electrical box
- Completely covers the mud ring and mounting screws
- For surface or flush mount applications

Other Features

- ETL Listed to UL 61010-1, CAN/CSA C22.2 No 61010-1
- Flame Rated 5VA, 80°C
- Not sold separately - factory installed with a new detector only



White Housing Specifications

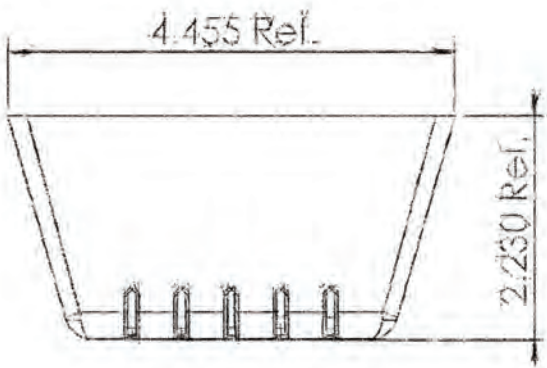
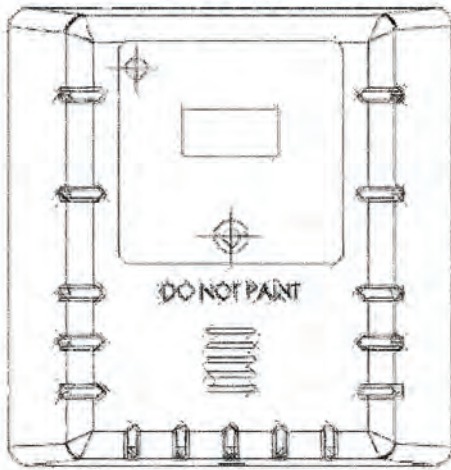
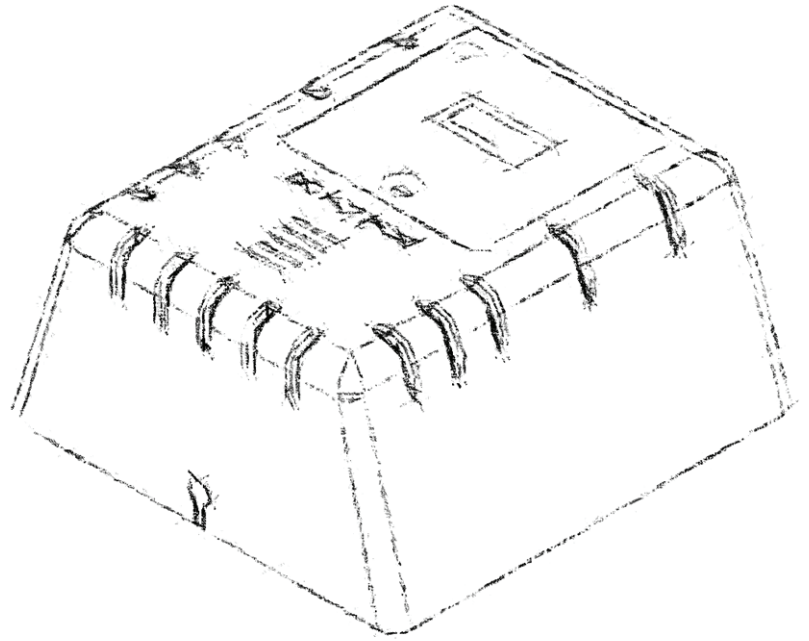
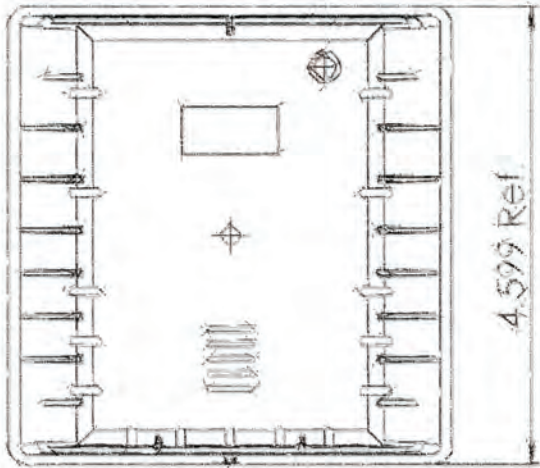

Made in the U.S.A. with US and imported materials

© Aerionics 2015. All rights reserved.
Macurco is a trademark of Aerionics, Inc.

